



DEER CREEK SOUTH VILLAS

ANKENY

PLAT 1&2

www.jerryshomes.com

School District

Ankeny

Nearest Grocery

Hy-Vee, Target
Walmart, Fareway

Nearest Gym

Aspen Athletic Club

Outdoor Amenities

Otter Creek Golf Course
Briarwood Golf Course

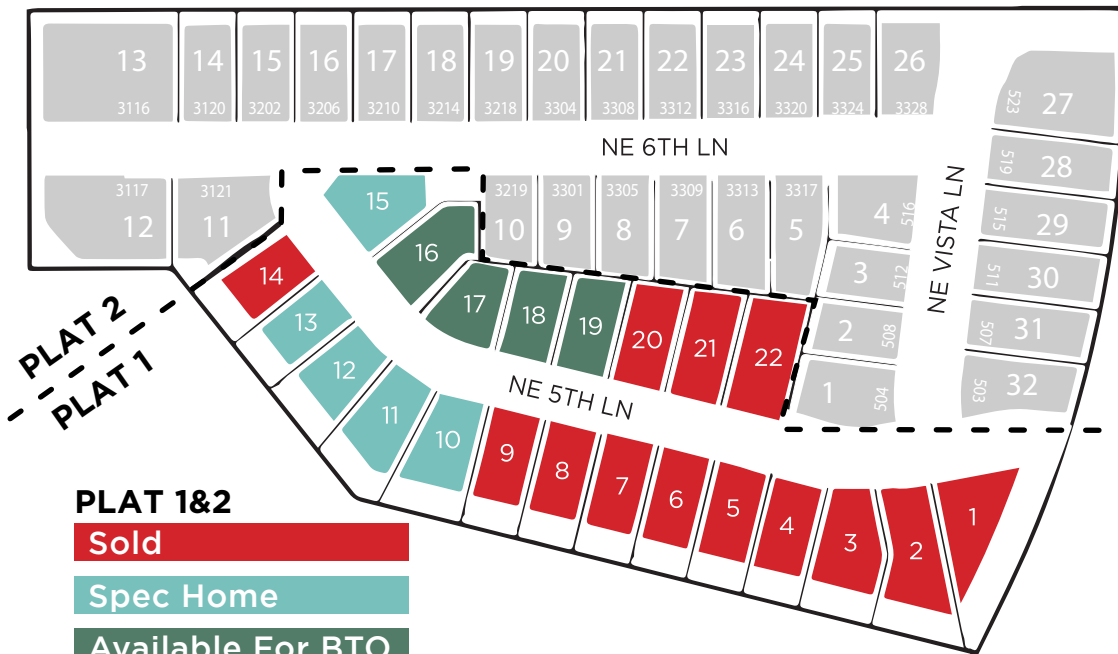

PLAT 1&2

Sold

Spec Home

Available For BTO

Coming Soon

The Crossings at Deer Creek is a quiet neighborhood tucked away in a beautiful area on the east side of Ankeny. Close to grocery stores, shopping and I-35 for a quick commute to both downtown Des Moines or Ames. Within the development are plans for both an elementary school and a large city park. The Crossings at Deer Creek is an incredible option for families looking for their next home in a convenient location.

LOT #	ADDRESS	TYPE	SQFT	PRICE	STYLE
10	3219 NE 5th LN	Walk-Out	8,866	\$282,930	COPELAND
11	3215 NE 5th LN	Walk-Out	8,783	\$284,266	DUKE
12	3211 NE 5th LN	Walk-Out	7,657	\$288,025	REED
13	3207 NE 5th LN	Walk-Out	7,010	\$279,900	WAYNE
15	3206 NE 5th LN	Standard	1,427	\$281,875	COPELAND

LOT #	ADDRESS	TYPE	LOT SQFT	PRICE
16	3210 NE 5th LN	Standard	7,267	\$51,000
17	3214 NE 5th LN	Standard	7,999	\$50,000
18	3218 NE 5th LN	Standard	6,227	\$50,000
19	3304 NE 5th LN	Standard	6,600	\$50,000

Tim Scheib 515.313.7103 timscheib@gmail.com

Rachel Scheib 515.238.1420 rachelmscheib@gmail.com

Listing information subject to change without notice.



#SINCE1957



Our history builds your future.

Daylight lots are an additional \$4,000 above listing price. Walkout lots are an additional \$7,000 above listing price.